

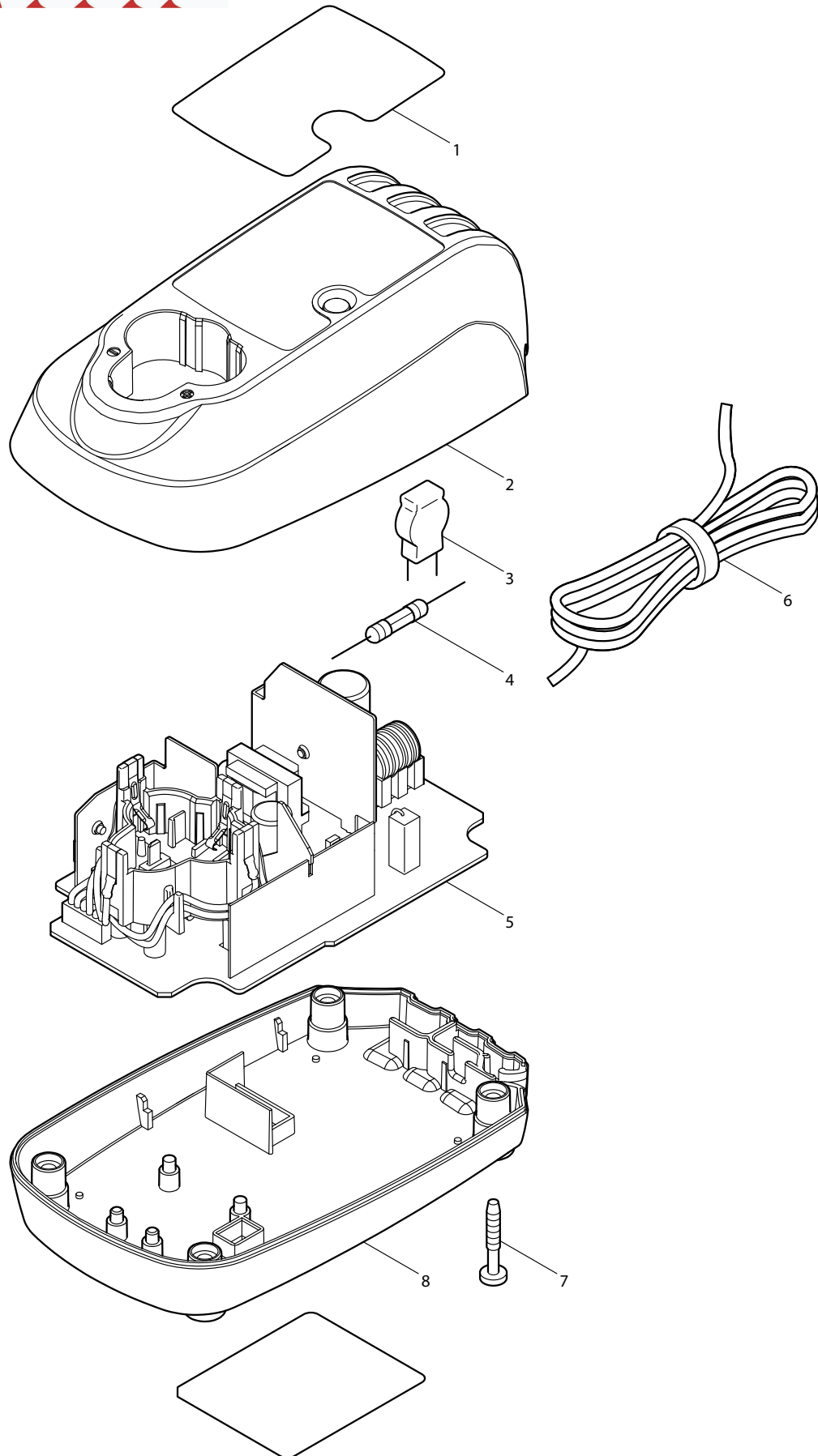

06 - 2008
DC10WA
DC10WA CHARGER



Item No.	Part No.	Description	Q'ty	Unit
1	806973-3	CHARGING CONDITION LABEL	1	PC.
2	158599-0	CHARGER CASE COMPLETE	1	PC.
3	647321-5	VARISTOR	1	PC.
4	652779-5	FUSE	1	PC.
5	631807-9	CHARGING CIRCUIT COMPLETE (INCLUDES ITEM 3 and 4)	1	PC.
6	667982-5	VINYL CORD #18-2-2.0	1	PC.
7	266355-5	TAPPING SCREW BT 4X25	4	PC.
8	450470-7	CHARGER CASE COVER	1	PC.

*** CHARGER INFORMATION ***

THIS CHARGER IS FOR:

MODEL NO.
DF030D, TD090D
TD020DSE, TD020DSEW
LCT203

BATTERY NO.
194551-4 - 10.8V LI-ION BATTERY BL1013 (1.3AH)
194356-2 - 7.2 LI-ION BATTERY BL7010 (1.0AH)