

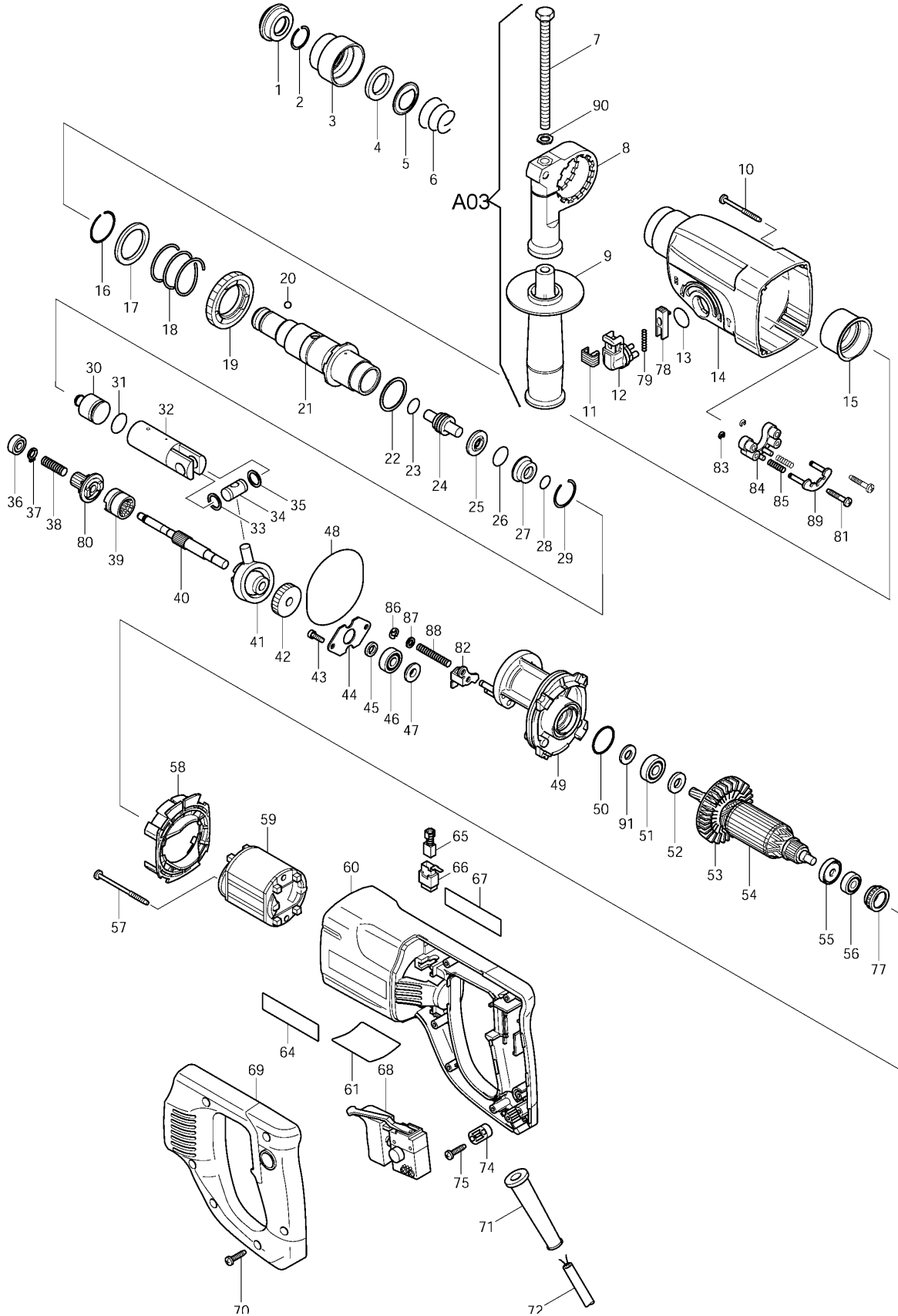

# 1" ROTARY HAMMER V.S. SDS-PLUS

Model HR2455 (MCC)

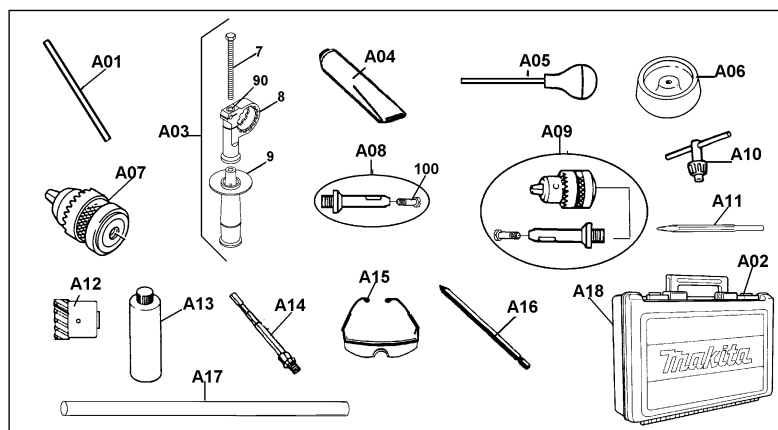

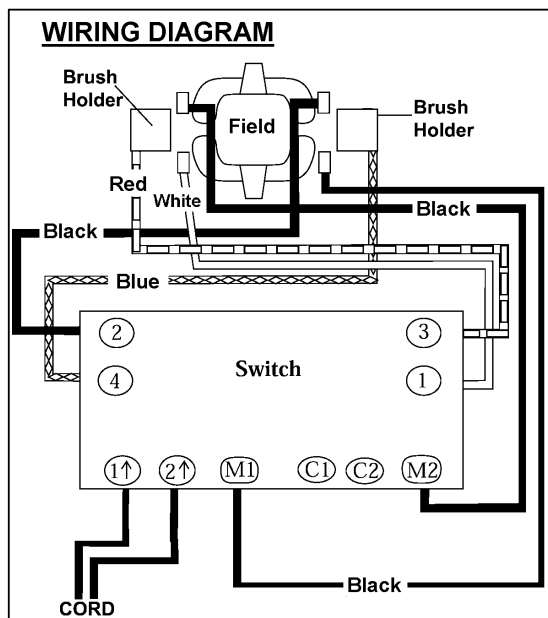

Item No.	Part No.	No. Used	Description	Item No.	Part No.	No. Used	Description
1	286263-4	1	Cap 35	36	211012-0	1	Ball Bearing 606ZZ
2	233915-8	1	Ring Spring 19	37	961003-8	1	Retaining Ring S-7
3	417629-9	1	Chuck Cover	38	233343-7	1	Compression Spring 7
4	257241-1	1	Ring 21	39	331634-1	1	Clutch Cam
5	345187-4	1	Guide Washer	40	324248-3	1	Cam Shaft
6	233916-6	1	Conical Compression Spring 21-29	41	219014-0	1	Swash Bearing 10
7	921923-8	1	Hex. Bolt M8X120	42	226550-9	1	Helical Gear 26
8	417630-4	1	Grip Base	43	266273-7	2	Hex. Socket Head Bolt M4X12
9	152521-9	1	Grip 36 Com.	44	345179-3	1	Bearing Retainer
10	266069-6	4	Tapping Screw 4X45	45	267234-0	1	Flat Washer 8
11	417794-4	1	Cap	46	211032-4	1	Ball Bearing 608ZZ
12	162229-7	1	Change Lever Com.	47	324212-4	1	Ring 8
13	213278-8	1	O Ring 17	48	213725-9	1	O Ring 68
14	183441-6	1	Gear Housing Set (Includes Item 15)	49	*	1	Inner Housing Com.
15	153290-5	1	Needle Bearing Com.	50	213380-7	1	O Ring 24
16	233918-2	1	Ring Spring 28	51	210060-6	1	Ball Bearing 609LLU
17	267228-5	1	Washer 30	52	267231-6	1	Flat Washer 9
18	233328-3	1	Compression Spring 31	53	240047-4	1	Fan 60
19	227028-5	1	Spur Gear 51	54	517376-3	1	Armature Assy (Includes Items 51-53, 55 & 56)
20	216022-2	1	Steel Ball 7.0	55	681636-0	1	Insulation Washer
21	153365-0	1	Tool Holder Com.	56	211021-9	1	Ball Bearing 607LLB
22	267229-3	1	Flat Washer 28	57	266052-3	2	Tapping Screw 4X60
23	213128-7	1	O Ring 12	58	418085-6	1	Baffle Plate
24	324396-8	1	Impact Bolt	59	633556-4	1	Field
25	324218-2	1	Ring 9	60	183580-2	1	Housing (Includes Items 64 & 67)
26	213232-2	1	O Ring 15	64	819064-1	1	Makita Mark
27	324216-6	1	O Ring Case	65	191927-6	2	Carbon Brush CB-407(2pcs/Set)
28	213073-6	1	O Ring 9	66	643936-6	2	Brush Holder
29	233917-4	1	Ring Spring 28	67	819064-1	1	Makita Mark
30	324214-0	1	Striker	68	650508-0	1	Switch
31	213227-5	1	O Ring 16	69	418086-4	1	Handle Cover
32	331632-5	1	Piston Cylinder	70	265995-6	6	Tapping Screw 4X18
33	267104-3	1	Flat Washer 12	71	682559-5	1	Cord Guard 8
34	324215-8	1	Piston Joint	72	664895-1	1	Cord With Plug 2P-18-4.0M
35	267104-3	1	Flat Washer 12	74	687063-9	1	Strain Relief

Item No.	Part No.	No. Used	Description	Item No.	Part No.	No. Used	Description
75	265995-6	2	Tapping Screw 4X18				
77	421494-0	1	Rubber Ring 19	A06	421342-3	1	Dust Cup 5 (6-14.5mm Bit Dia.)
78	417795-2	1	Lock Button		421664-1	1	Dust Cup 9 (12-16mm Bit Dia.)
79	233341-1	1	Compression Spring 3				
80	226399-7	1	Spur Gear 10	A07	763047-2	1	½" Drill Chuck
81	265999-8	2	Tapping Screw 4X25	A08	122573-4	1	Chuck Adaptor (Includes Item 100)
82	*	1	Change Plate	A09	122574-2	1	Drill Chuck Assy (Includes Items A07 & A08)
83	961017-7	2	Stop Ring E-3	A10	763432-9	1	Chuck Key
84	417796-0	1	Guide Base				
85	233344-5	2	Compression Spring 4				
86	961011-9	1	Stop Ring E-4				
87	941102-2	1	Flat Washer 5				
88	233342-9	1	Compression Spring 6	A11	-----	1	Bull Point, Cold Chisel, Grooving Chisel, Scaling Chisel (See Catalogue for Details)
89	163430-7	1	Lock Plate Com.				
90	345280-4	1	Hex. Washer	A12	-----	1	Core Bit (See Catalogue for Details)
91	267271-4	1	Flat Washer 9	A13	181490-7	1	Hammer Grease 30cc
100	251425-3	1	(-) Flat Head Screw M6X22	A14	A-86642	1	Core Bit (SDS Plus)
<b>Accessories</b>				A15	191686-A	1	Makita Safety Glasses
A01	324219-0	1	Depth Gauge	A16	752031-2	1	Center Bit
A02	417724-5	2	Latch	A17	256806-6	1	Rod (For 25-40mm)
A03	134943-5	1	Grip 36 Assy (Includes Items 7-9 & 90)		256815-5	1	Rod (For 45-118mm)
A04	181573-3	1	Bit Grease	A18	824695-3	1	Plastic Carrying Case (Includes Item A02)
A05	765009-6	1	Blow-Out Bulb				

\* SEE SERVICE CHANGES

## SERVICE CHANGES

### 1. Modification of Inner Housing Com and Change Plate.

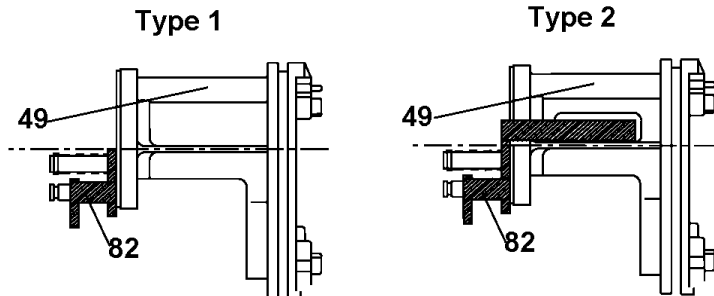

Item No.	Description	Type 1	Type 2	Type 3
49	Inner Housing Com	153367-6	153610-3	<b>153687-8</b>
82	Change Plate	345220-2		<b>345363-0</b>
91	Flat Washer 9	-----	267271-4	
	Implementation		~ Oct 2003	Nov 2003 ~

Above parts are completely interchangeable as a set.

## SERVICE NOTE

### Follow these steps when replacing the Inner Housing Com and the Change Plate.

1. Remove Gear Housing Cover.
2. Remove Tool Holder section.
3. Remove two M4x12 Hex. Socket Head Bolts. (Fig. 1)

Fig. 1

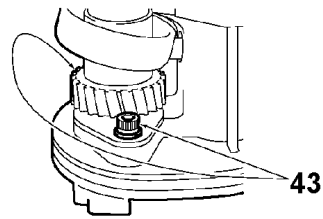

4. Remove Shaft portion and Piston Cylinder. (Fig. 2)

Fig. 2

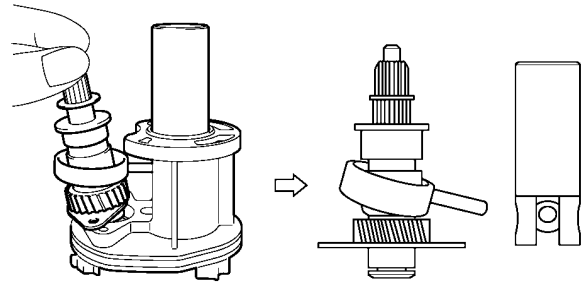

5. Remove Change Plate. (Fig. 3)

Fig. 3

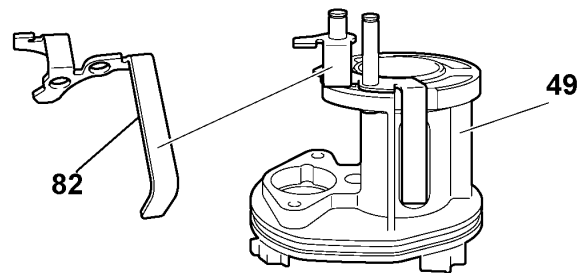

6. Remove O-Ring 24 and O-Ring 68. (Fig. 4)

Fig. 4

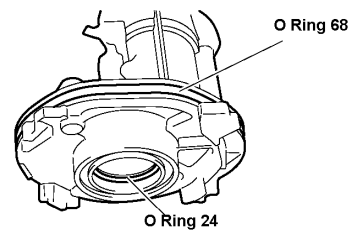

All steps for removal of re-use parts have now been completed.

7. Replace the current Inner Housing complete by the new one.
8. Apply 5g of Makita Grease RA No.1 as (Fig. 6)

Fig. 6

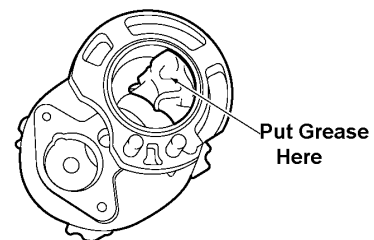

9. Install O-Ring 24 and O-Ring 68 as (Fig. 4)

Fig. 4

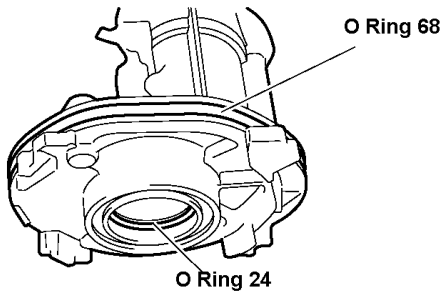

10. Set the new Change plate to the new Inner housing complete (Fig. 10).

Fig. 10

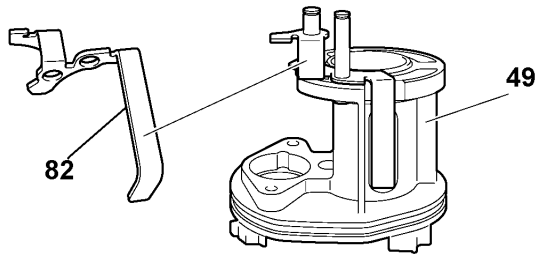

11. Fix The Current Shaft Section And Pliston Cylinder with Inner Housing, and then secure them by screwing the new M4x12 Hex. Socket Head Bolts (2pcs). Next, Set the following parts on Pin 6 shown in Fig 11.

- Stop Ring E-4
- Compression Spring 6
- Flat Washer 5

Fig. 11

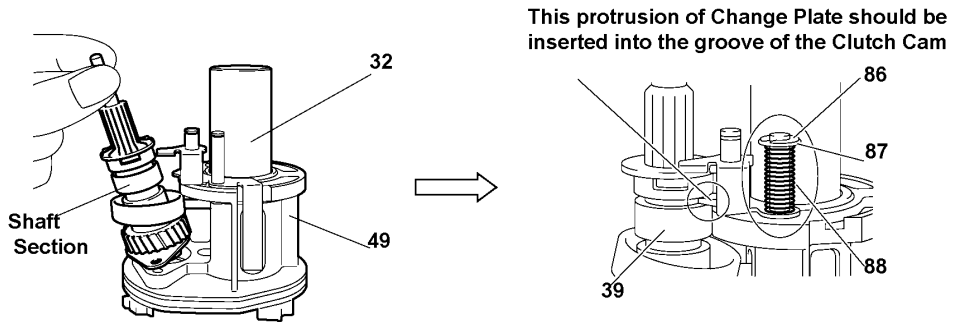

**Supplementary information:** Check whether Flat Washer 9 can be seen on the Armature Shaft as Fig. 12 by removing the Armature from the machine. If not, put Flat Washer 9 (Part No. 267271-4) as shown in (Fig 12)

